

MTS

Product of the VOLLMER Group

tool-kit PROFESSIONAL by MTS – Product of the VOLLMER Group

Software-Modul

Spezifikation „Taps/GMENU“

Stand: 30.01.25

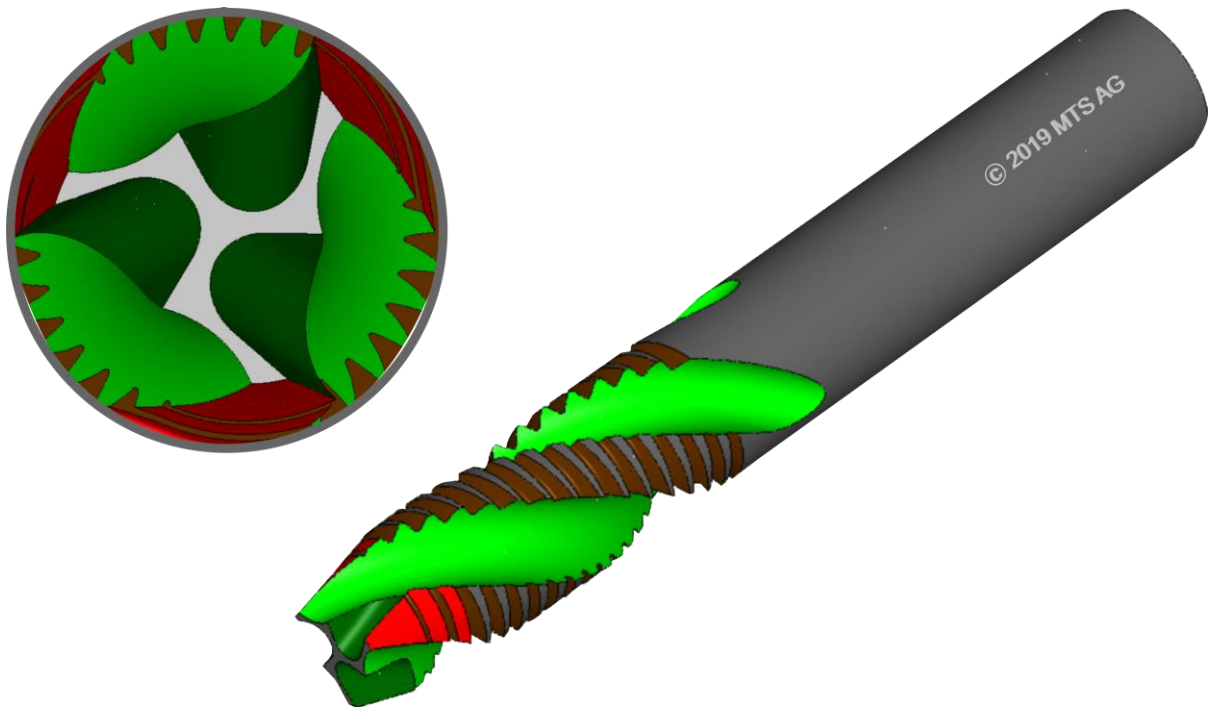

VOLLMER WERKE Maschinenfabrik GmbH
MTS
Innovationszentrum Freiburg (FRIZ)
Georges-Köhler-Allee 302
79110 Freiburg im Breisgau
Tel.: +49 7351 571 8141 / +49 160 5426017
info-mts@vollmer-group.com
www.mts-toolkit.com

MTS

Product of the VOLLMER Group

9.1 Taps

1GMENU

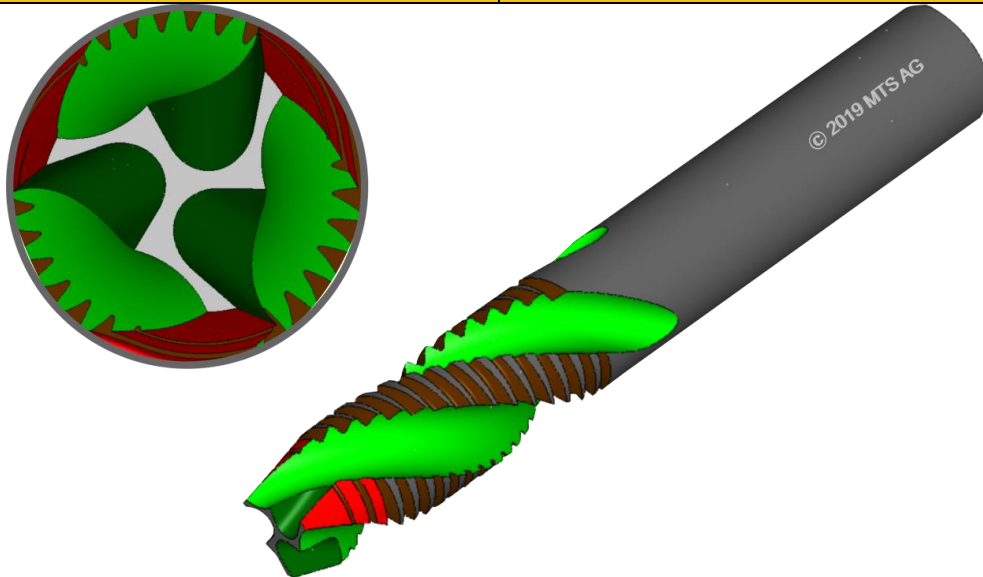

9.1 Basic Modul Taps

- **End Face:**
 - Plan Face
 - Centering Point
 - Clearance
 - Centering P. + Clearance
 - Spigot
- **Cutting Edge Combination:**
 - right helix/right cutting
 - left helix/right cutting
 - left helix/left cutting
 - right helix/left cutting
- **Preparation:**
 - Separation
 - Profile roughing
 - Profile finishing
- **Main Fluting:**
 - Using standard- or radius wheels
- **Chamfer:**
 - Type of grinding: longitudinal/transverse
 - Chamfer angle
 - Chamfer length
 - Chamfer radial relief
- **Gashing:**
 - Radial cut angle
 - Axial cut angle
 - With radius- or rounded cup wheel

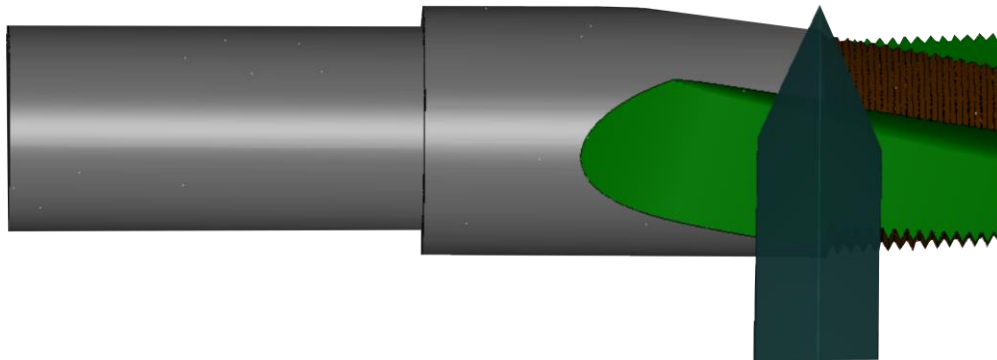

9.2 Taps Produktion
Extension to 9.1

- **Tap production:**
Production by profile-wheel
(Wheel-definition by DXF- or point
discription)
Radial relief